

Saw Arm Assembly

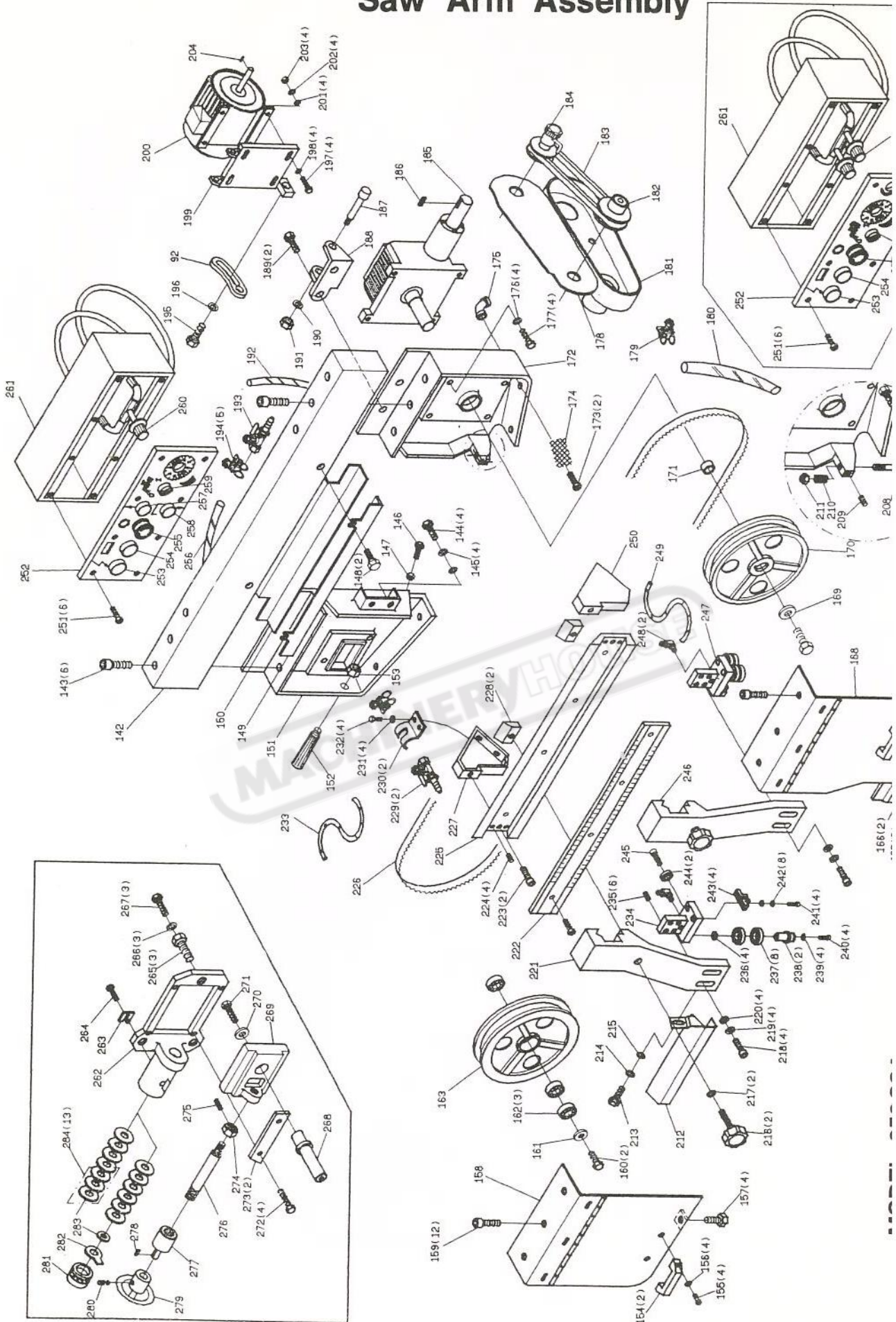

Base and Bed Assembly

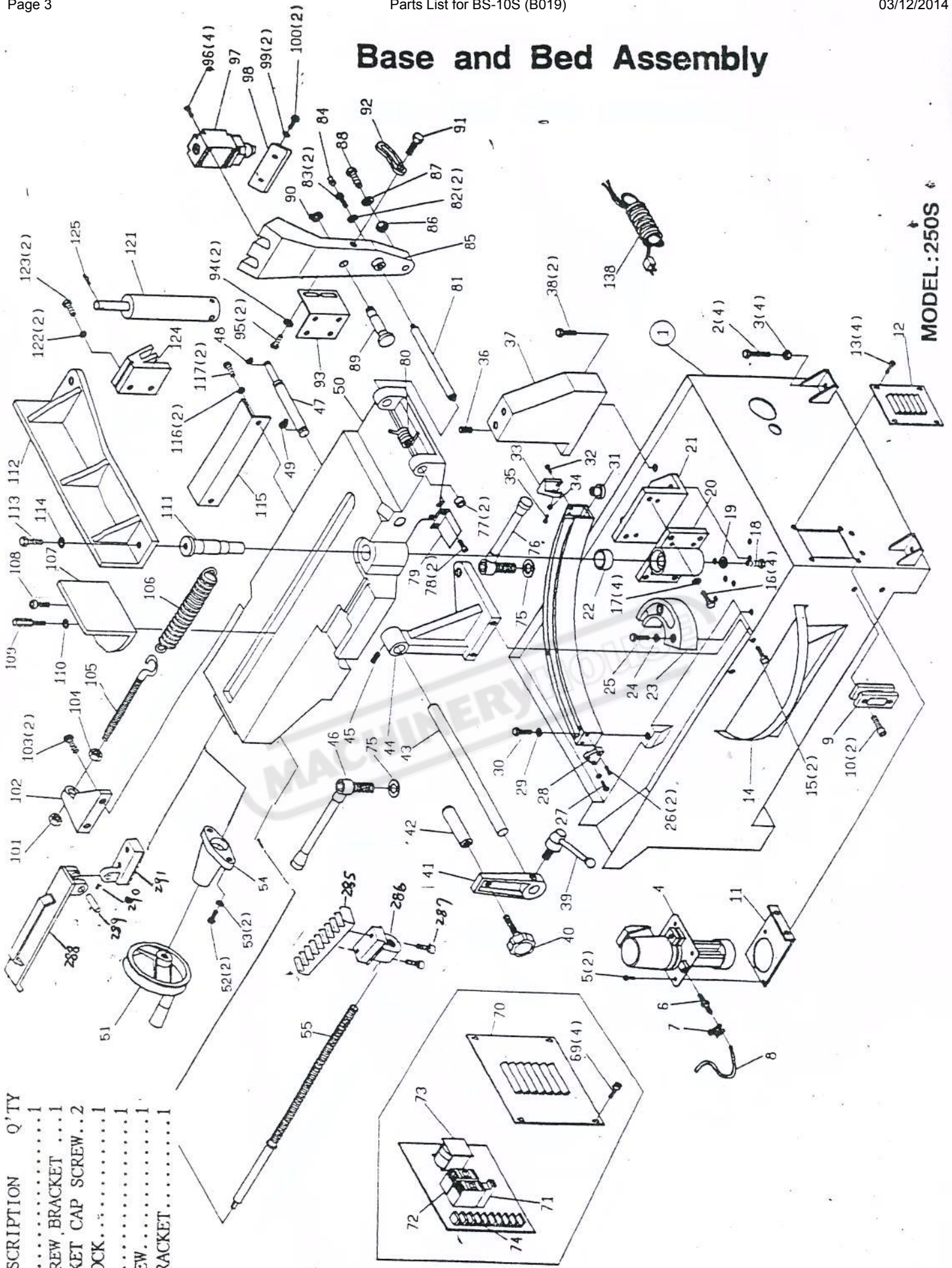

MODEL:250S

DESCRIPTION	Q'TY
285...RACK.....	1
286...JEAD SCREW BRACKET ...	1
287...HEX SOCKET CAP SCREW..	2
288...RACK BLOCK.....	1
289...PIN.....	1
290...SET SCREW.....	1
291...SLIDE BRACKET.....	1

PART LIST

PART NO.	DESCRIPTION	SIZE NO.	Q'TY	PART NO.	DESCRIPTION	SIZE NO.
1	BASE		1	71	FUSE BLOCK	
2	HEX CAP BOLT	M12X70	4	72	MAGNETIC SWITCH(1PH/3PH)	
3	HEX NUT	M12	4	73	TRANSFORMER(1PH/3PH)	
4	COOLANT PUMP (1PH/3PH)		1	74	TERMINAL STRIP	
5	PAN HEAD SCREW	M6X16	2	75	WASHER	M16
6	HOSE FITTING		1	76	ADJUSTABLE HANDLE	
7	HOSE CLAMP		1	77	NEEDLE BEARING	
8	HOSE		1	78	HEX CAP SCREW	M6X12
9	COLLANT GAUGE		1	79	GUIDE PLATE	
10	HEX CAP BOLT	M10X30	2	80	TORSION SPRING	
11	COOLANT PUMP BRACKET		1	81	PIVOT SHAFT	
12	PANEL COVER		1	82	WASHER	M12
13	HEX SOCKET CAP BOLT	M6X8	4	83	BOLT W/ZERK FITTING	
14	TURN PLATE		1	84	BRASS FITTING	
15	HEX CAP BOLT	M8X16	2	85	PIVOT BRACKET	
16	HEX CAP BOLT	M12X30	4	86	NUT	M12
17	WASHER	M12	4	87	WASHER	M12
18	HEX CAP BOLT	M8X16	1	88	HEX CAP BOLT	M12X40
19	WASHER		1	89	TORSION SPRING SHAFT	
20	TURNING SLIDE BRACKET		1	90	C-RING	S-22
21	CENTER FIXED BRACKET		1	91	HEX CAP BOLT	M8X25
22	THRUST BEARING		1	92	MOTOR TILT PLATE	
23	TURNING SLIDE		1	93	LIMIT SWITCH PLATE	
24	WASHER	M10	1	94	WASHER	M8
25	HEX CAP BOLT	M10X40	1	95	HEX CAP BOLT	M8X10
26	HEX SOCKET CAP SCREW	M6X20	2	96	HEX CAP SCREW	M6X12
27	HEX SOCKET CAP SCREW	M6X20	1	97	LIMIT SWITCH	
28	BRACKET		1	98	PLATE	
29	WASHER	M10	1	99	WASHER	M12
30	HEX CAP BOLT	M10X40	1	100	HEX CAP BOLT	M12X50
31	SLIDE		1	101	HEX NUT	1/2"
32	HEX SOCKET CAP SCREW	M6X20	4	102	SPRING BRACKET	
33	BRACKET		1	103	HEX CAP BOLT	M8X30
34	HEX NUT	M10	1	104	HEX NUT	1/2"
35	HEX SOCKET CAP SCREW	M10X25	1	105	ADJUSTABLE C-BOLT	
36	SET SCREW	M8X16	1	106	SPRING	
37	BRACKET		1	107	WISE JAW - LEFT	
38	HEX CAP BOLT	M12X35	2	108	HEX CAP BOLT	M12X35
39	LOCK HANDLE		1	109	LOCK KNOB	
40	LOCK KNOB		1	110	LOCK WASHER	M12
41	STOP BRACKET		1	111	CUTTER PIN	
42	WORK STOP		1	112	FIXED VISE JAW	
43	STOP ROD		1	113	HEX CAP BOLT	M12X40
44	SUPPORT		1	114	LOCK WASHER	M12
45	SET SCREW	M8X10	1	115	SPRING COVER	
46	ADJUSTABLE HANDLE		1	116	LOCK WASHER	M10
47	CYLINDER PIN		1	117	HEX CAP BOLT	
48	C-RING	S-20	1	118	HEX SOCKET CAP SCREW	M8X30
49	C-RING	S-25	2	119	SPRING	
50	BED		1	120	HYDRAULIC CYLINDER ASSEMBLY	
51	HAND WHEEL ASSEMBLY		1	121	SPRING COVER	
52	HEX CAP BOLT	M8X30	2	122	LOCK WASHER	M10
53	LOCK WASHER	M8	2	123	HEX CAP BOLT	M10X30
54	LEAD SCREW SEAT		1	124	HYDRAULIC MOUNTING PLATE-TOP	
55	LEAD SCREW		1	125	CUTTER PIN	
56	LEAD SCREW BRACKET		1	126	CYLINDER PIN -TOP	
57	ACME NUT		1	127	HEX CAP SCREW	M6X12
58	BUTTON		1	128	LOCK WASHER	M6
59	RETAINER		2	129	METAL SHEET,SMALL	
60	PAN HEAD SCREW	M5X8	1	130	HEX CAP SCREW	M6X12
61	HEX SOCKET CAP BOLT	M6X8	4	131	ROD OF MICRO SWITCH FOR LENGTH	
62	ELECTRIC CABINET BOX		1	132	LIMIT SWITCH	
63	MAGNETIL SWITCH		1	133	LIMIT SWITCH PLATE	
64	FUSE		1	134	HEX CAP SCREW	M8X50
65	TRANSFORMERS		1	135	HEX NUT	M8
66	PIN		2	136	WASHER	M10
67	TERMINAL STRIP		1	137	HEX , HEAD SCREW	M10X25
68	GENERAL SWITCH		1	138	POWER CORD(1PH/3PH)	
69	HEX SOCKET CAP BOLT	M6X8	4	139	HYDRAULIC PUMPSET	
70	ELECTRICAL PANEL COVER		1	140	DOOR	

PART LIST

PART NO.	DESCRIPTION	SIZE NO.	Q'TY	PART NO.	DESCRIPTION	SIZE NO.	Q'TY
141	HEX SOCKET CAP BOLT	M6X8	4	214	LOCK WASHER	M8	1
142	COLUMN		1	215	WASHER	M8	1
143	HEX SOCKET CAP SCREW	M12X20	6	216	KNOB		2
144	HEX CAP BOLT	M12X30	4	217	WASHER	M10	2
145	LOCK WASHER	M12	4	218	HEX SOCKET CAP SCREW	M8X40	4
146	HEX CAP BOLT	M12X60	1	219	LOCK WASHER	M8	4
147	HEX NUT	M12	1	220	WASHER	M8	4
148	LOCK KNOB		2	221	ADJUSTABLE BRACKET		1
149	BLADE GUARD		1	222	SCALE		1
150	BLADE GUARD -DOWN		1	223	HEX SOCKET CAP SCREW	M10X25	2
151	WHEEL BOX -LEFT		1	224	SET SCREW	M8X10	4
152	HANDLE		1	225	SLIDE		1
153	HEX NUT	M12	1	226	BLADE(LOCAL PURCHASE)		1
154	HANDLE		2	227	BLADE BRACKET -LEFT		1
155	PAN HEAD SCREW	M6X16	4	228	CLAMP		2
156	WASHER	M6	4	229	ADJUSTING VLAVE		2
157	LOCK KNOB		4	230	CLAMP		1
158	BLADE WHEEL COVER -LEFT		1	231	LOCK WASHER	M6	4
159	HEX SOCKET CAP SCREW	M6X8	12	232	HEX CAP BOLT	M6X12	4
160	HEX CAP BOLT	M12X25	2	233	HOSE		1
161	WASHER	M12	1	234	GUIDE BRACKET -LEFT		1
162	BALL BEARING		3	235	HEX SOCKET CAP SCREW	M8X16	6
163	IDLER WHEEL		1	236	WASHER	M8	4
164	HEX CAP BOLT	M6X12	2	237	BALL BEARING		8
165	LOCK WASHER	M6	2	238	ECCENTRIC SLEEVE		2
166	WASHER	M6	2	239	LOCK WASHER	M8	4
167	WIRE BRUSH GUARD		1	240	HEX SOCKET CAP SCREW	M8X45	4
168	BLADE WHEEL COVER -RIGHT		1	241	HEX SOCKET CAP SCREW	M6X30	4
169	WASHER		1	242	WASHER	M6	8
170	DRIVE WHEEL		1	243	BLADE GUIDE		4
171	BUSHING		1	244	BALL BEARING		2
172	BLADE WHEEL BOX -RIGHT		1	245	HEX SOCKET CAP SCREW	M8X20	1
173	PAN HEAD SCREW	M5X10	2	246	ADJUSTABLE BRACKET -RIGHT		1
174	FILTER SCREEN		1	247	GUIDE BRACKET -RIGHT		1
175	CONNECTOR		1	248	CONNECTOR		2
176	LOCK WASHER	M12	4	249	HOSE		1
177	HEX CAP BOLT	M12X35	4	250	BLADE BRACKET -RIGHT		1
178	PULLEY COVER PLATE		1	251	PAN HEAD SCREW	M5X10	6
179	HOSE CLAMP		1	252	CONTROL PANEL		1
180	HOSE		1	253	POWER INDICATOR LIGHT		1
181	PULLEY COVER		1	254	START SWITCH		1
182	GEAR BOX PULLEY		1	255	STOP SWITCH		1
183	V-BELT		1	256	HOSE		1
184	MOTOR PULLEY		1	257	UP SWITCH		1
185	GEAR BOX ASSEMBLY		1	258	DOWN SWITCH		1
186	KEY	7MM	1	259	PUMP SWITCH		1
187	SUPPORT SHAFT		1	260	FEED CONTROL-HYDRAULIC ON/OFF VALVE		1
188	MOTOR MOUNT BRACKET		1	261	CONTROL BOX		1
189	HEX CAP BOLT	M12X30	2	262	SLIDE BRACKET		1
190	WASHER	M12	1	263	INDICATOR SCALE		1
191	HEX NUT	M12	1	264	PAN HEAD SCREW	M5X10	2
192	HOSE		1	265	HEX CAP SCREW		3
193	CONNECTING TUBE		1	266	LOCK WASHER		3
194	HOSE CLAMP		5	267	SCREW ASSEMBLY		3
195	SCREW		1	268	WHEEL SHAFT		1
196	WASHER	M8	1	269	SLIDE		1
197	HEX CAP BOLT	M8X45	4	270	WASHER	M12	1
198	WASHER	M8	4	271	HEX SOCKET CAP SCREW	M8X25	1
199	MOTOR MOUNT PLATE		1	272	HEX SOCKET CAP SCREW	M8X25	4
200	MOTOR		1	273	GIB		2
201	WASHER	M8	4	274	HEX NUT	M12	1
202	LOCK WASHER	M8	4	275	SET SCREW	M6X8	1
203	HEX NUT	M8	4	276	TENSION SHAFT		1
204	KEY	7MM	1	277	EXTENSION BAR		1
205	HEX CAP BOLT	M6X10	1	278	KEY	5MM	1
206	WASHER	M6	1	279	HANDWHEEL		1
207	WIRE BRUSH		1	280	SET SCREW	M8X10	1
208	WIRE BRUSH ROD		1	281	THRUST BEARING		1
209	SET SCREW	M6X8	1	282	TENSION INDICATOR		1
210	SPRING		1	283	FLAT STEEL WASHER		1
211	HEX NUT	M10	2	284	LOCK WASHER	M22	13
212	BLADE GUARD		1				
213	HEX CAP BOLT	M8X16	1				